

Opposite the Sun Is Where the Blue Sky Lies

Works from the Hara Museum and the Hara Rokuro Collections

Part I - Summer Selection: June 30 (Fri.) – September 3 (Sun.), 2023 Hara Museum ARC Kankai Pavilion

■ List of Works

* See other side for notes regarding works marked by an asterisk.

** Part of paintings used for wallpaper and sliding doors at Nikko-in guest hall in Miidera temple.

- | | | |
|--|---|---|
| 1 *
Anish Kapoor
<i>Void</i>
pigment, fiberglass
128 x 97 x 92.5 cm
1992 | 6
<i>Bird-shaped Celadon water pitcher vase</i>
porcelain
Goryeo dynasty,
10-14th century, Korea | 10
Yoshihiro Suda
<i>This water unfit for drinking – Clematis</i>
wood
variable size
2001/2020 |
| 2 *
Willem de Kooning
<i>Untitled</i>
oil on newspaper
69.5 x 86.8 cm
1967 | 7 *
Mori Tetsuzan
<i>A hundred cranes</i>
pair of six fold screen
color on paper
Edo period, 19th century | 11
<i>Tiered of boxes with hydrangeas design in maki-e</i>
Edo period, 19th century |
| 3 - 5
Robert Mapplethorpe
<i>Flower #2</i>
gelatin silver print
34.5 x 34.5 cm
1979
<i>Flower #1</i>
gelatin silver print
35 x 35 cm
1981
<i>Flower #3</i>
gelatin silver print
48.3 x 38.3 cm
1977 | 8 *
Roy Lichtenstein
<i>Stretcher Frame with Cross Bars IV</i>
oil on canvas
140 x 170 cm
1968
9
Minami Tada
<i>Ultra Volume - a</i>
polyester resin, vaporific coating aluminium
15 x 15 x 15 cm
1978 | 12
Tani Buncho
<i>Landscape</i>
hanging scroll
ink on silk
Edo period, dated 1839
13
<i>Sword case with clematis and "gunbai" (signal baton) design in maki-e</i>
Edo period, 18th century |

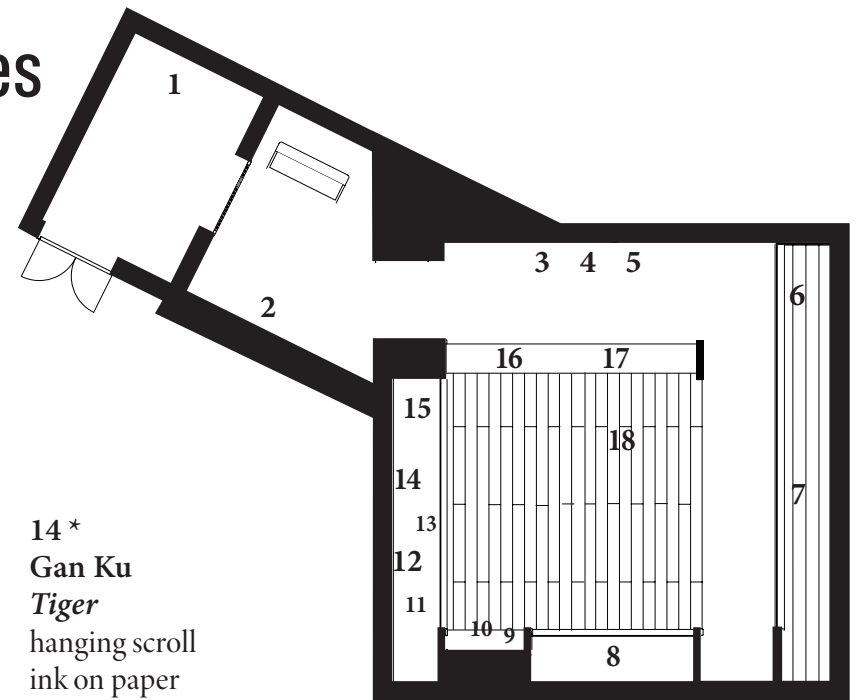

14 *
Gan Ku
Tiger
hanging scroll
ink on paper
Edo period, dated 1799

15
Tani Buncho
Two-paneld "furosaki" screen with a design of scuttered fans
one of two fold screen
color on silver-leaf paper
Edo period, 19th century

16
Hon'ami Koetsu
Waka poem "Kokin Waka-shu," first part of "Spring" chapter with painted ground and butterfly design
ink on decorated paper
Edo period, 17th century

17 *
Koetsu-bon Noh song book
wooden letterpress printing
Edo period, 17th century

18 *
Yves Klein
Untitled Blue Sponge Sculpture (SE 164)
dry pigment and synthetic resin on natural sponge and metallic rod
41.5 x 22.5 x 15.5 cm
1959